

MAINTENANCE TOOLS

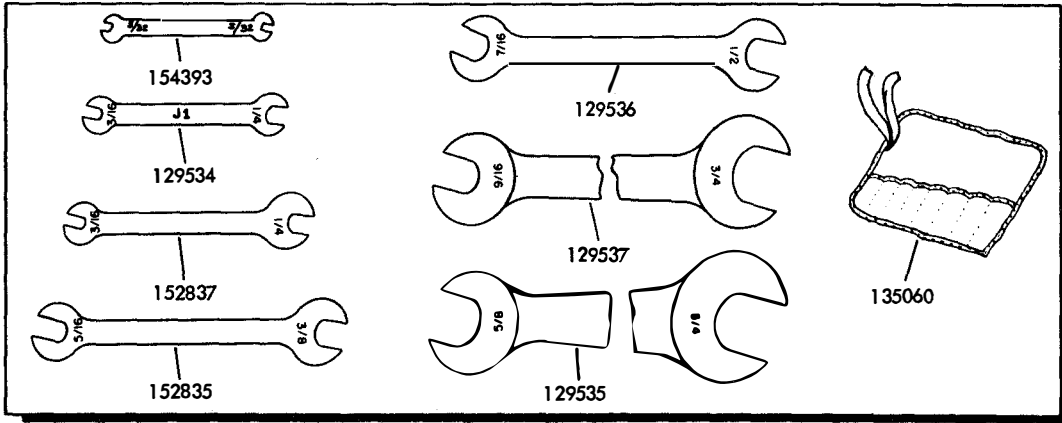

113756

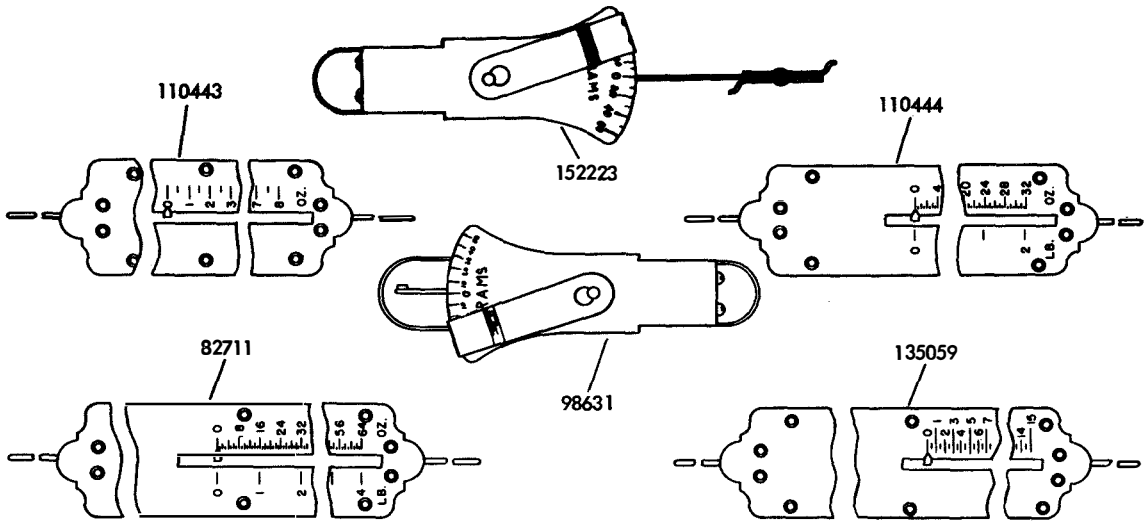
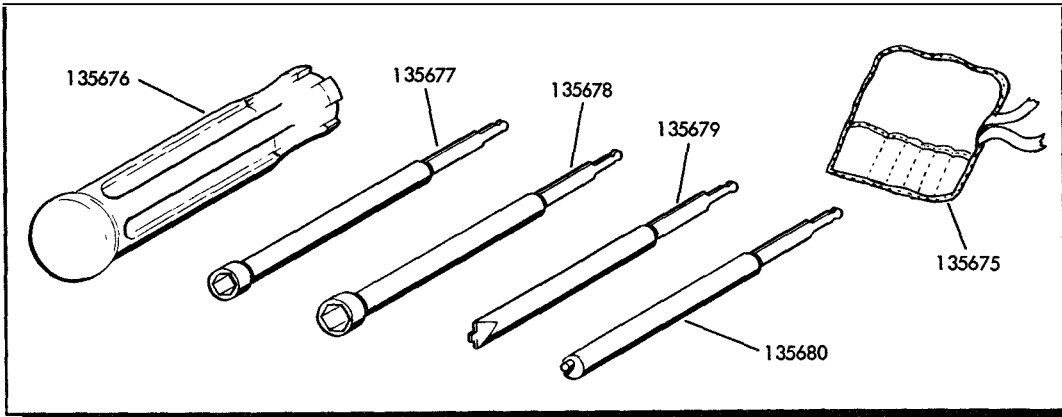

113777

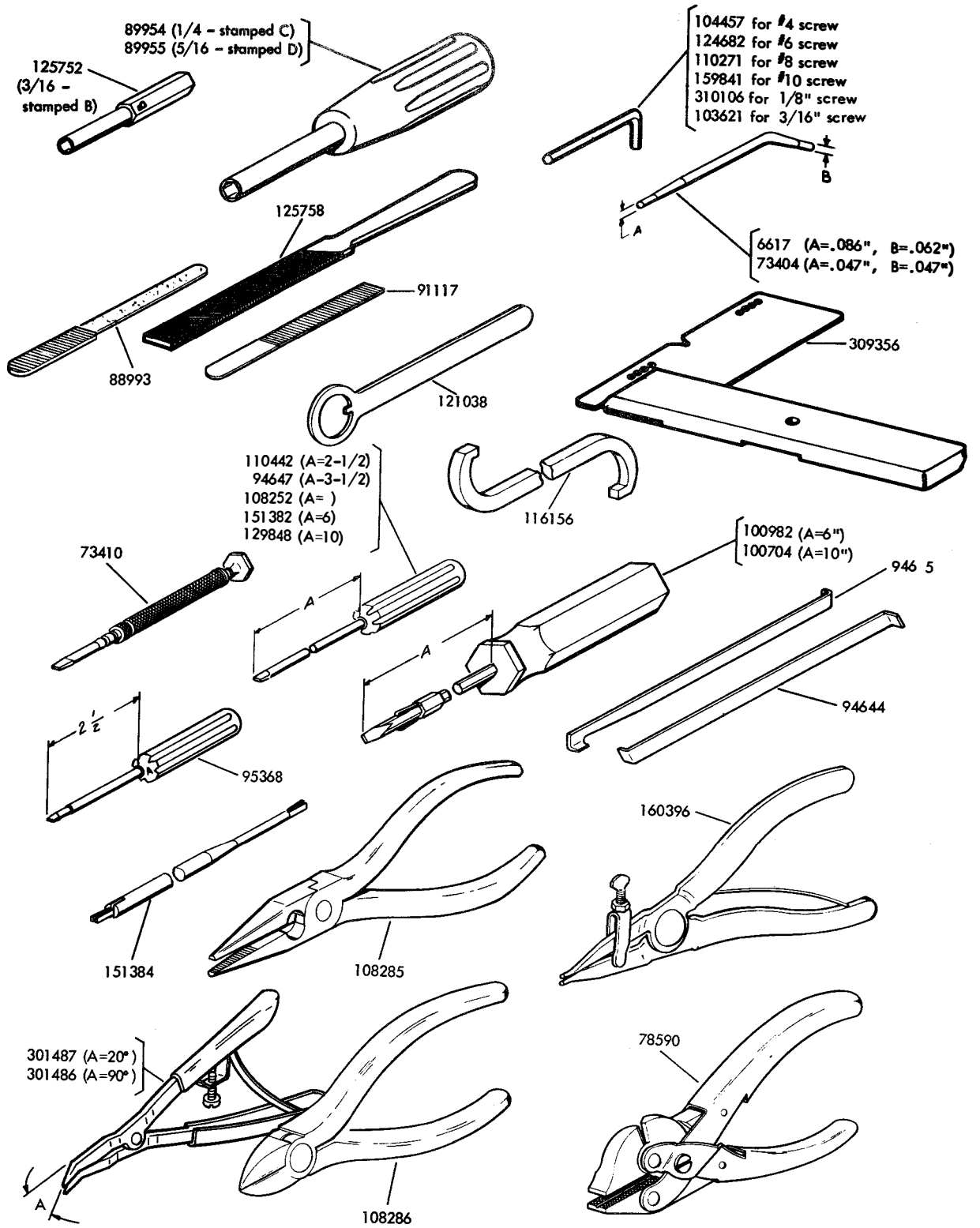

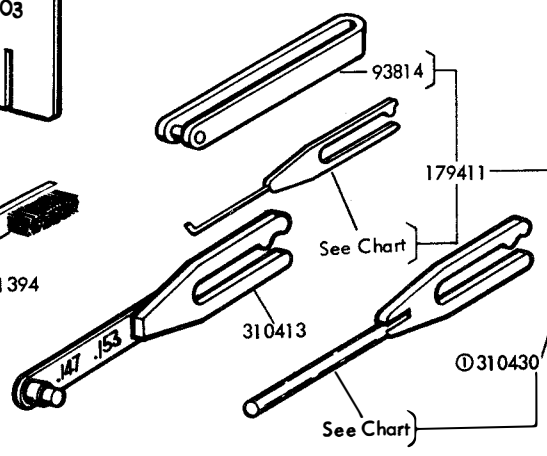
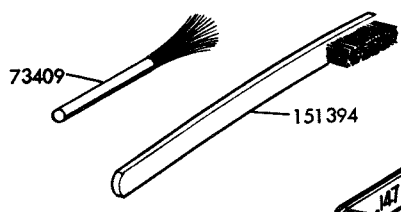
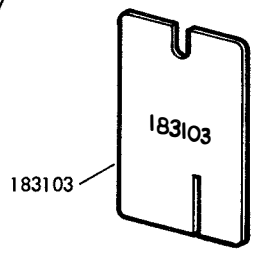
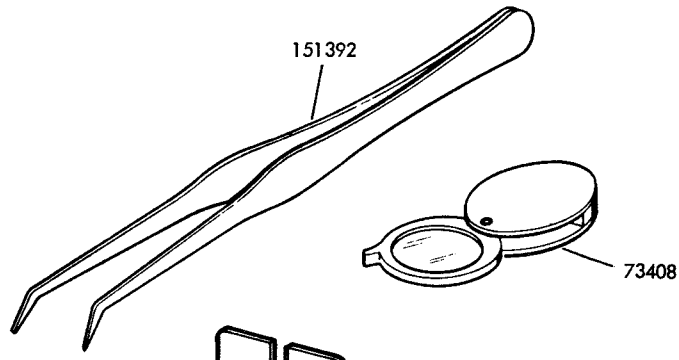
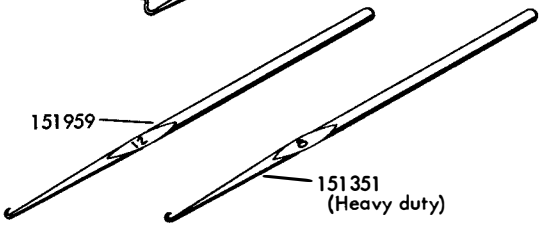
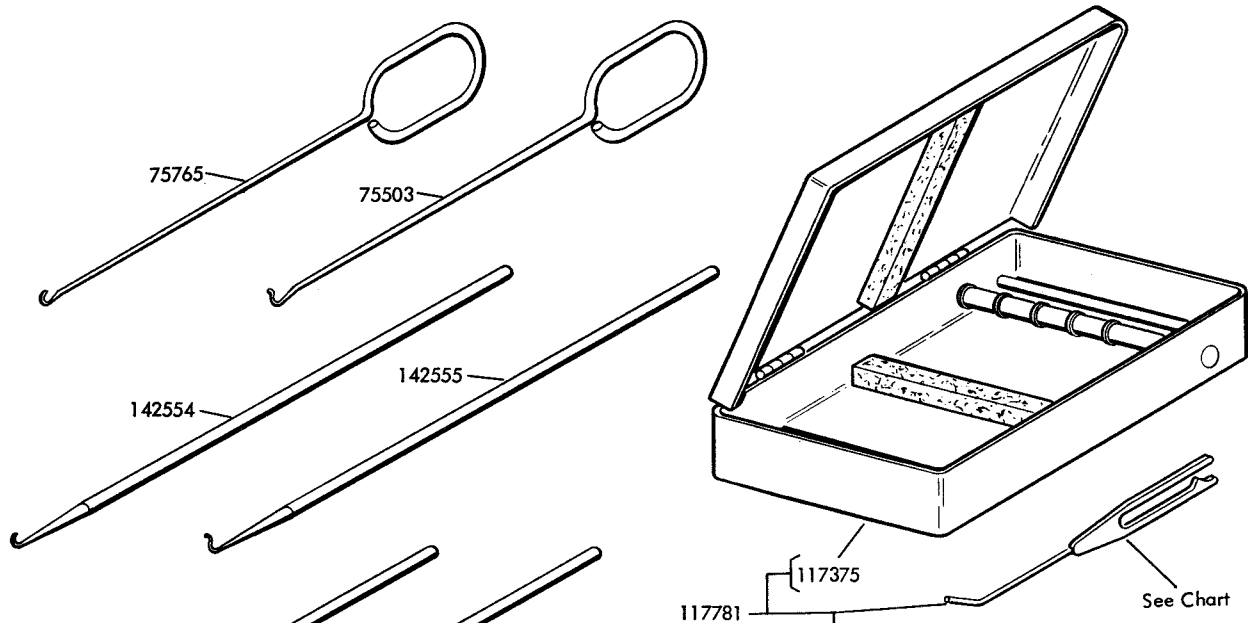

Gauge Chart		
Thickness	Shape	Part Number
.002	Flat	96356
.002	Flat-Brass	96358
.003	Flat	93833
.004	Flat	93822
.005	Flat	93823
.006	Flat	96360
.006	Round	96369
.007	Flat - Phos. Bronze	96362
.008	Round	96371
.010	Round	96373
.010	Flat	96364
.012	Round	93828
.015	Round	96375
.018	Round	93824
.020	Round	96377
.025	Round	93825
.027	Round	96352
.030	Round	93811
.035	Round	96383
.037	Round	98136
.040	Round	96385
.045	Round	96389
.050	Round	96391
.055	Round	93827
.060	Round	96393
.065	Round	96399
.070	Round	96401
.075	Round	96403
.080	Round	96405
.090	Round	179407
.100	Round	179408
.110	Round	179409
.120	Round	179410
.130	Round	310420
.135	Round	310421
.140	Round	310422
.145	Round	310423
.147	Round	310413
& .153	Round	310413
.150	Round	310424
.280	Round	310425
.320	Round	310426

Ⓞ Includes 117375 Case

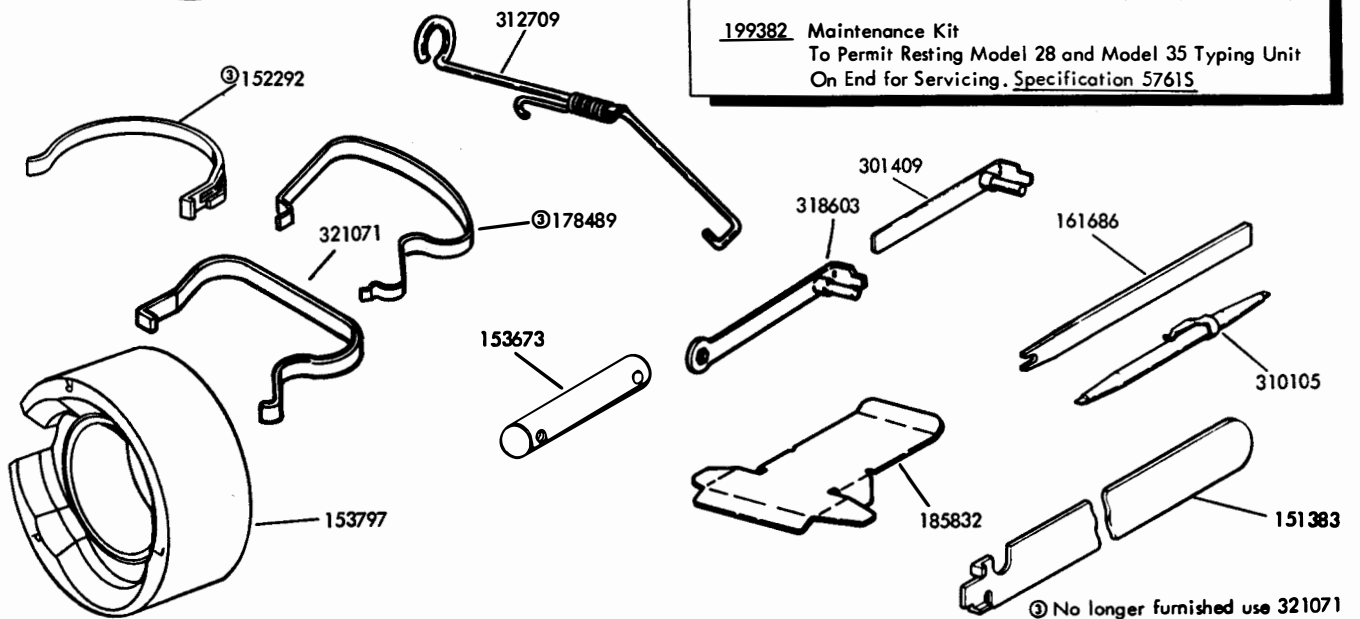
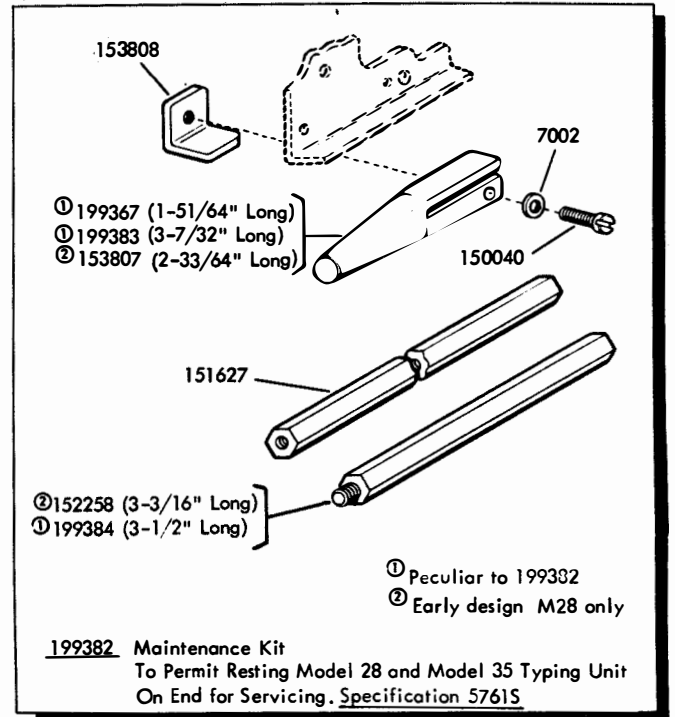
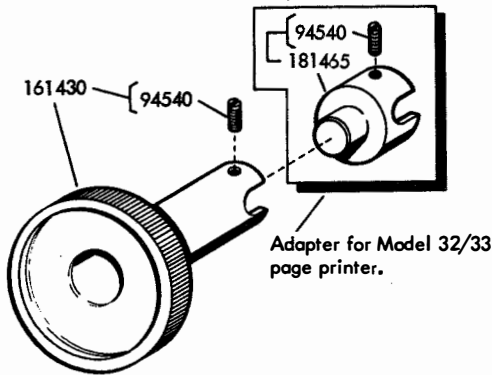
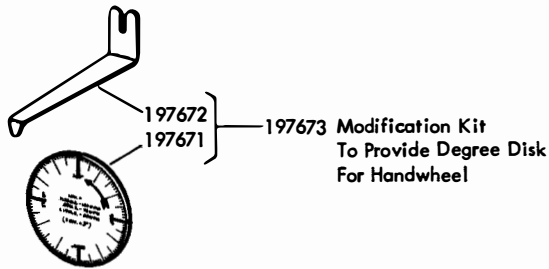
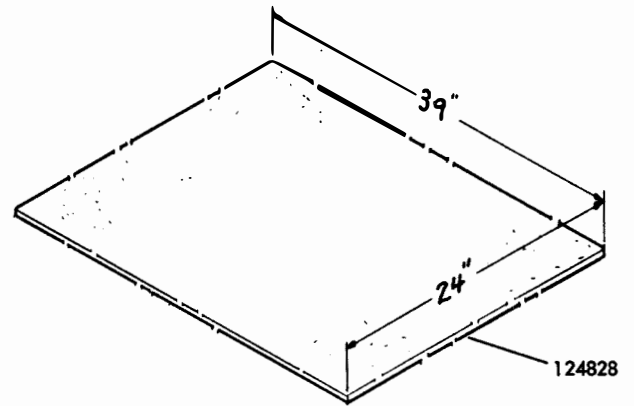
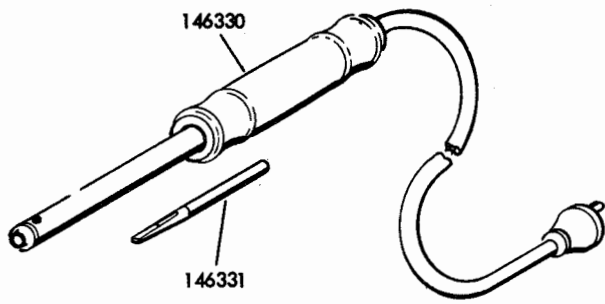

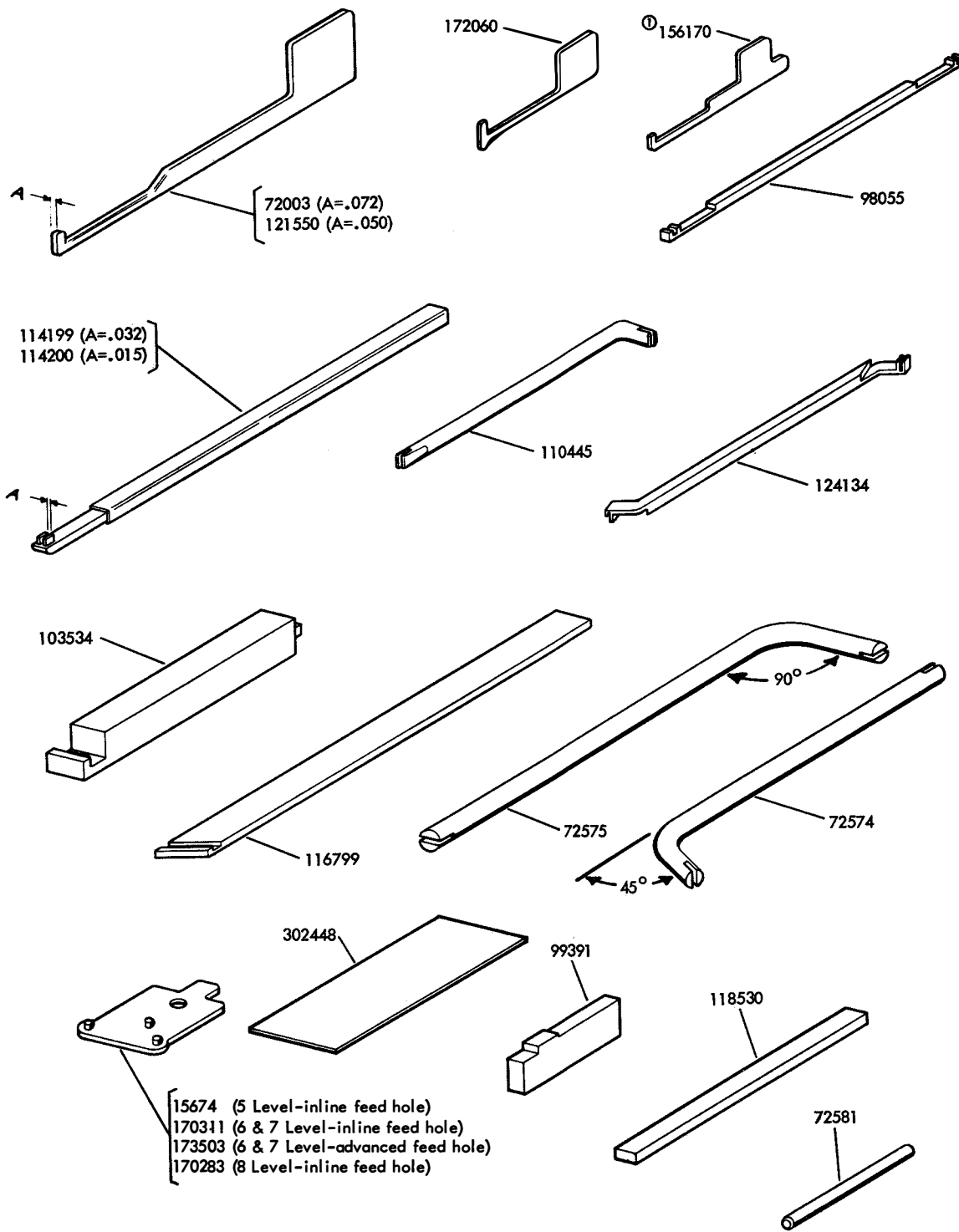

① No longer furnished use 172060

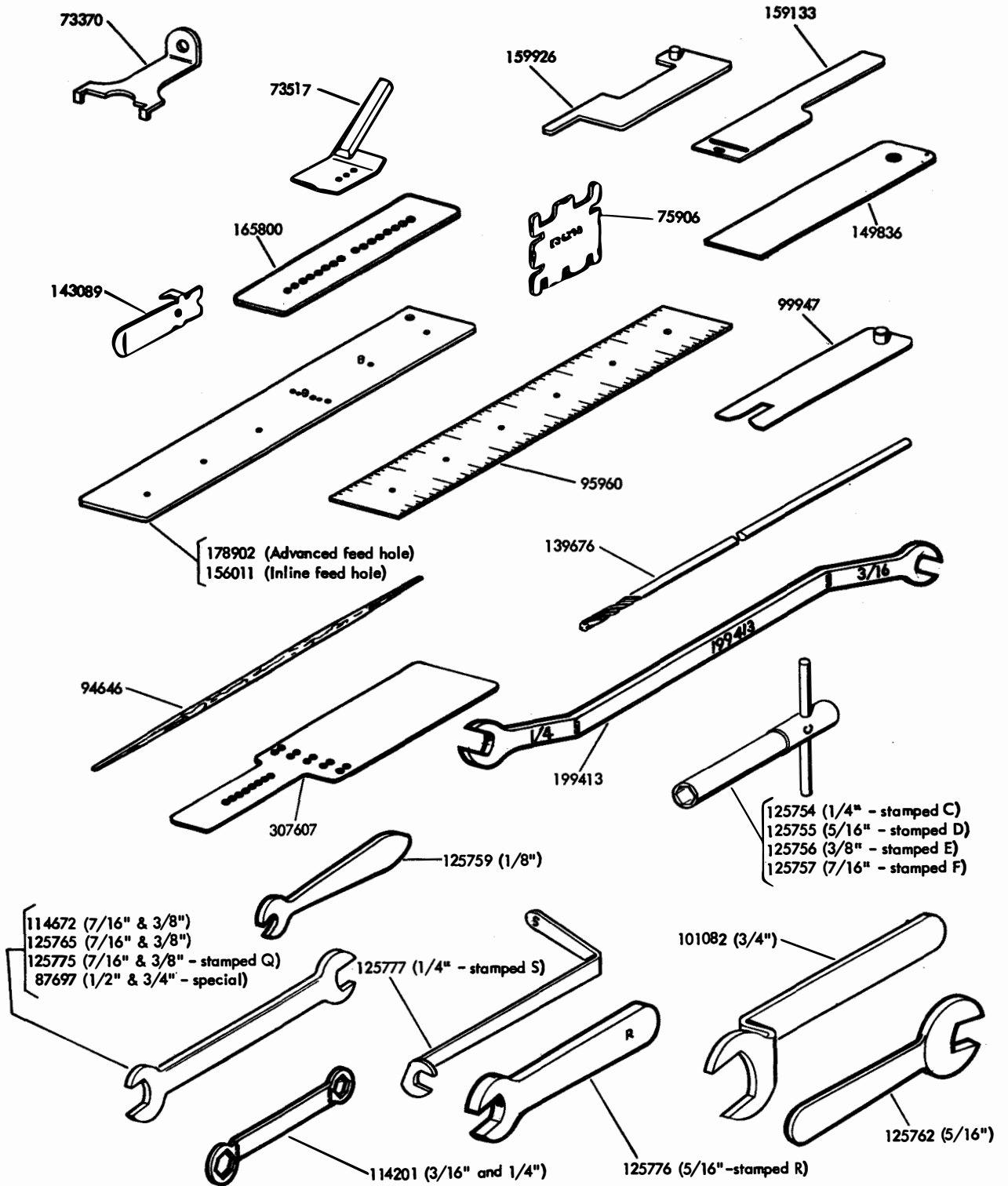

SECTION 570-005-800

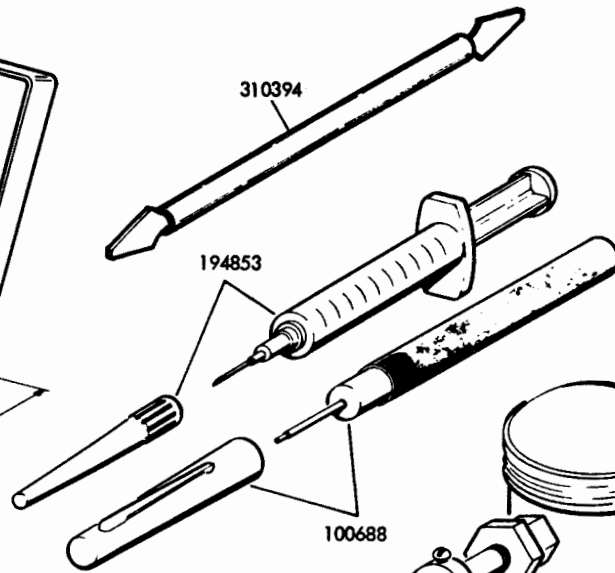
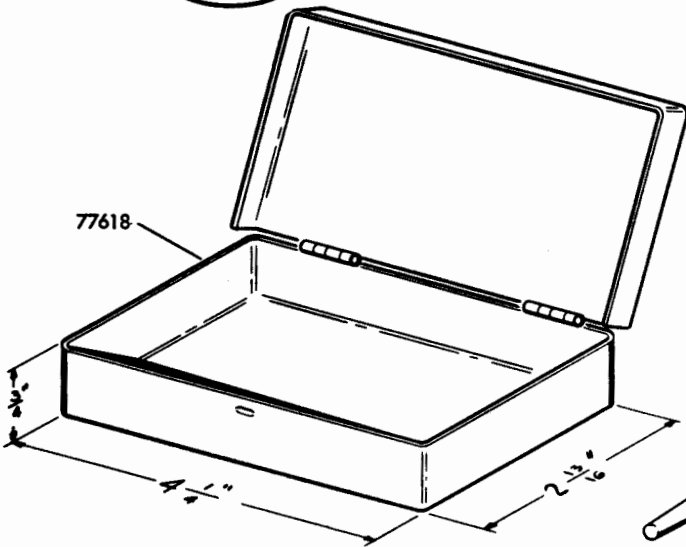
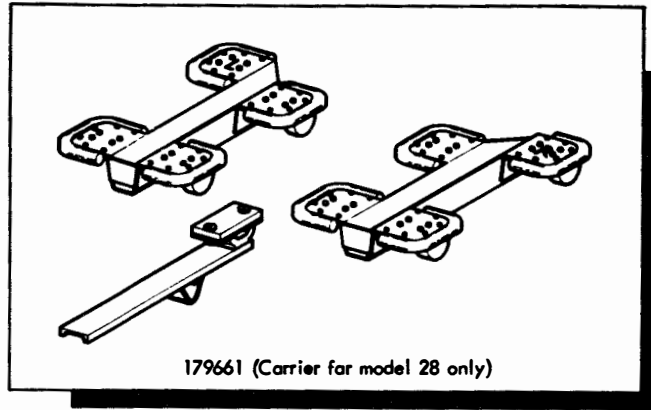
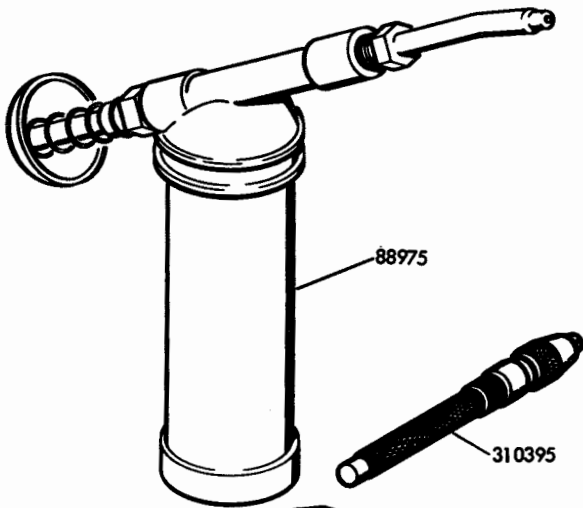

104986 (120VPS)  
103628 (87.6VPS)

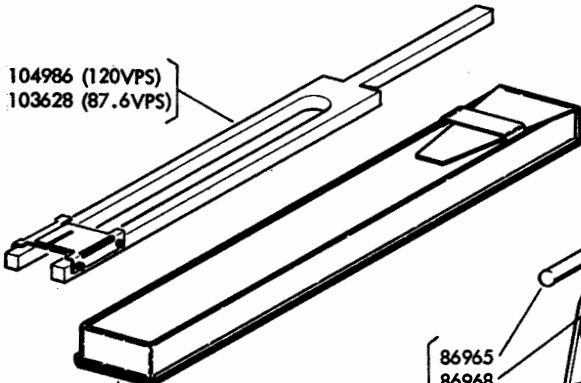

104262

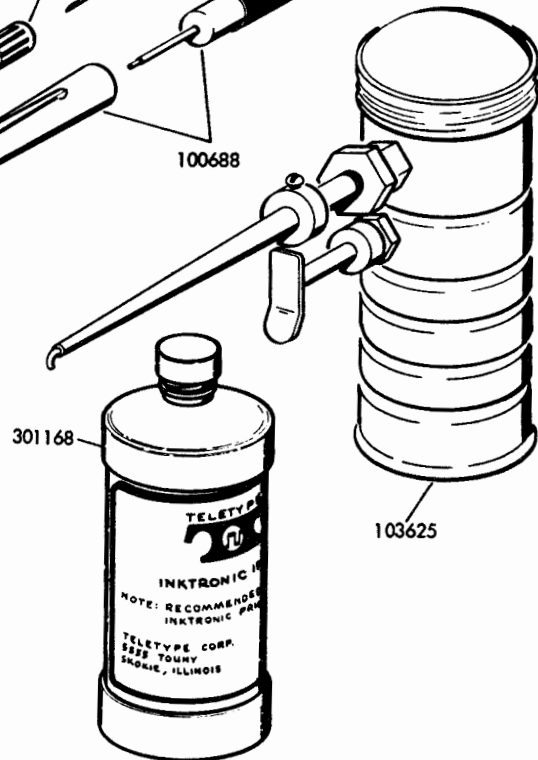
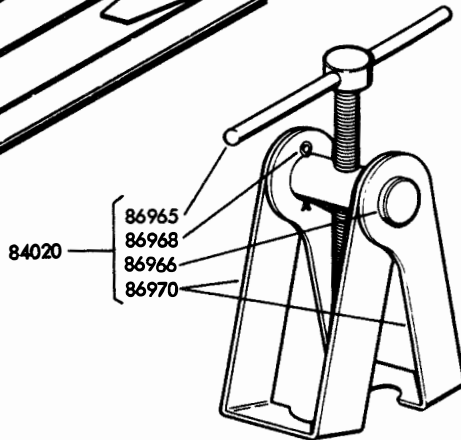



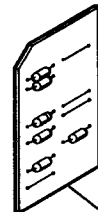
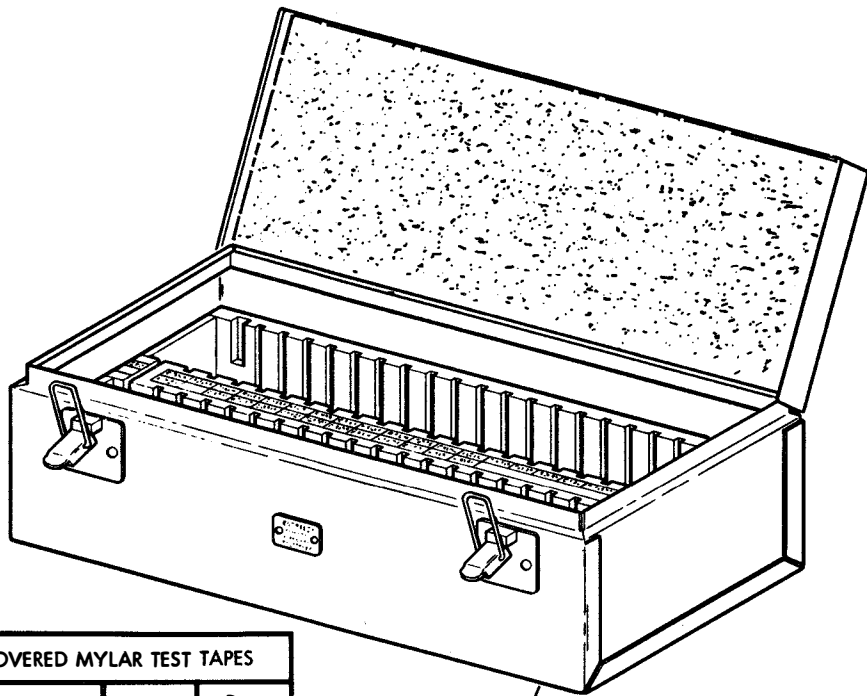

Circuit Card  
See Chart

PAPER COVERED MYLAR TEST TAPES		
Description	Code	Part Number
27 Repetitions of 14 Character Patterns	5 Level	146605
27 Repetitions of 14 Character Pattern	8 Level	146606
27 Repetitions of 14 Character Pattern	6 Level	146861
78 Repetitions of 14 Character Pattern	5 Level	148101
78 Repetitions of 14 Character Pattern	8 Level	148102
189 Repetitions of 2 Character Pattern	8 Level	148554
"Brown Fox" Sequence	5 Level	305734
	8 Level	305735
17" of repeated letters Character Pattern	5 level	320279

146540 { 146538

146539 Spare Circuit Card Kit			
Designation	Part Number	Designation	Part Number
EC321	172321	EC374	172374
EC322	172322	EC375	172375
EC323	172323	EC385	172385
EC324	172324	EC394	172394
EC325	172325	EC395	172395
EC326	172326	EC396	172396
EC333	172333	EC401	172401
EC347	172347	EC420	172420
EC351	172351	EC431	172431
EC352	172352	EC469	172469
EC355	172355	EC473	172473
EC359	172359	EC475	172475
EC361	172361	EC490	172490
EC363	172363	EC520	146520
EC365	172365	EC521	146521

172450 Extension Card Assembly (15 Pin)  
148454 Extension Card Assembly (36 Pin)

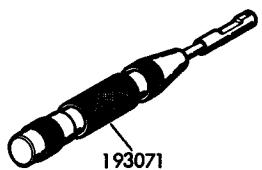

193071

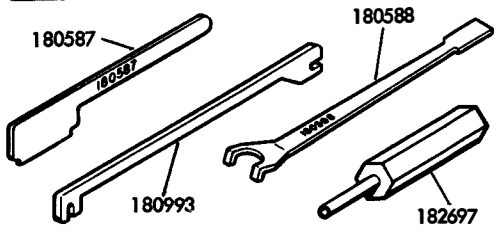

180587

180588

180993

182697

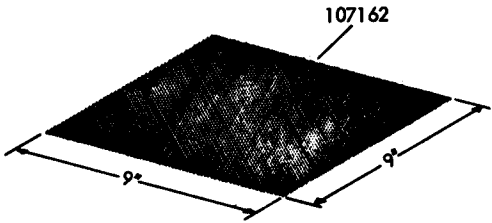

107162

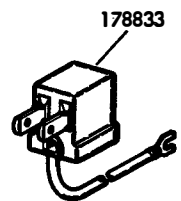

178833

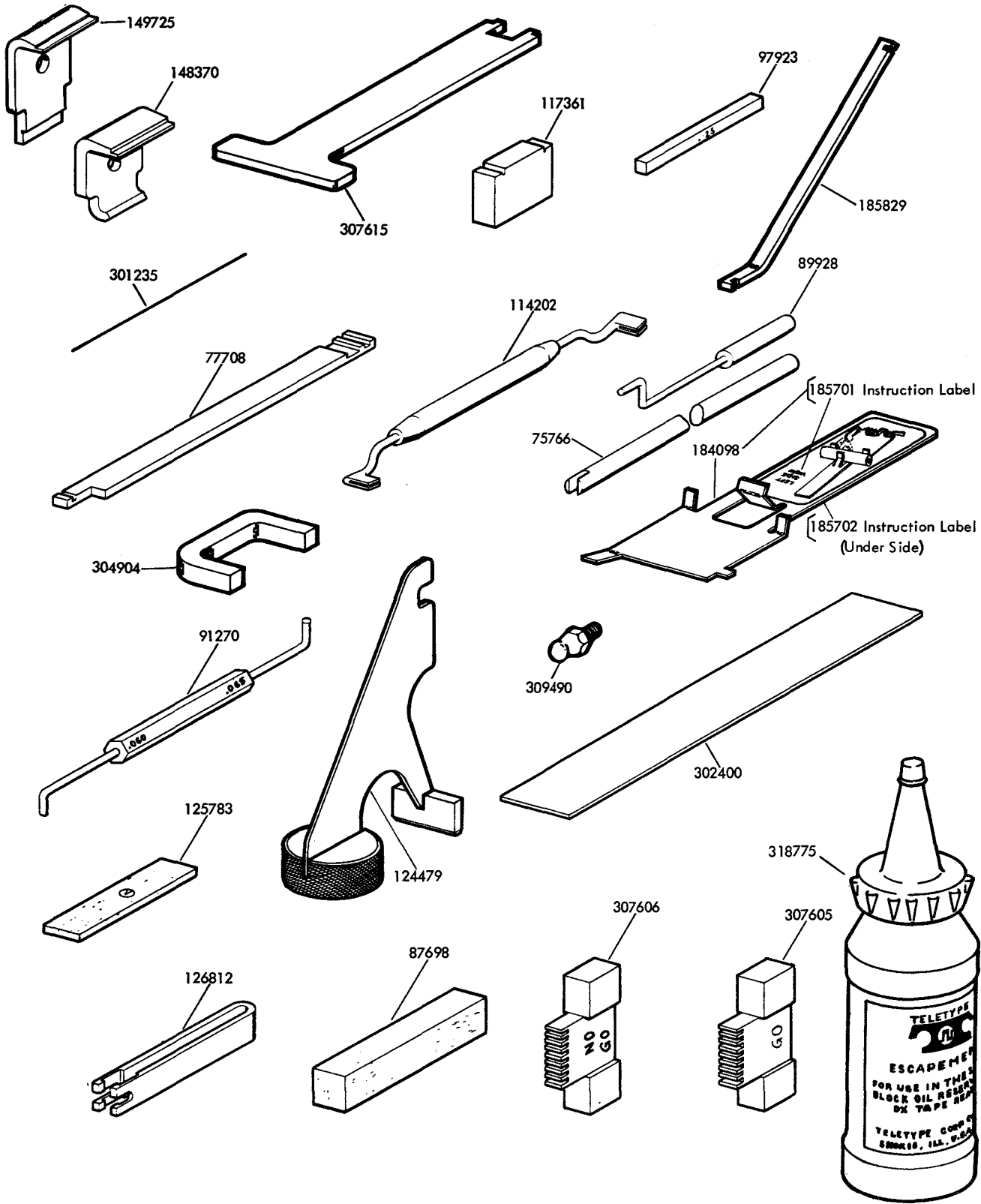

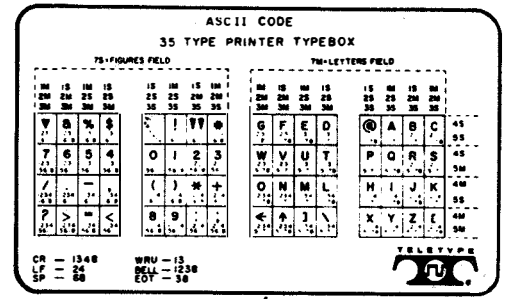
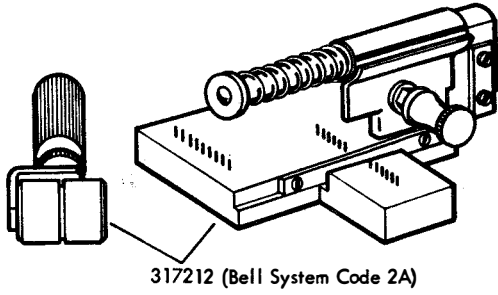

321942

SPLICING PATCHES				
CODE LEVELS	TELETYPE PART NO.	COLOR CODE	FEED HOLES	PATCH WIDTH
5	317325	BLUE	IN LINE	11/16
6	317326	RED	ADVANCED	7/8
7	317327	LAVENDER	IN LINE	7/8
8	317328	GREEN	IN LINE	1"

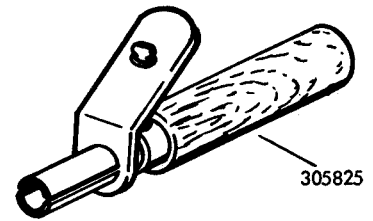
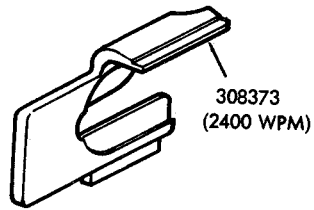
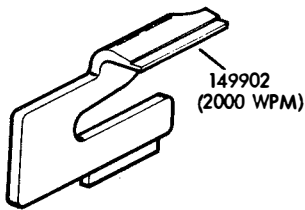

TOUCH UP PAINT - 1 PINT								
Air Dry Brush Enamel						Air Dry Brush Lacquer		
Smooth Finish			Wrinkle Finish			Smooth Vinyl		
Color	Teletype Code	Part Number	Color	Teletype Code	Part Number	Color	Teletype Code	Part Number
Black High Gloss	BA	143431	Black	AA	120820	Light Olive Gray	HF	304364
Black Semi-Gloss	BB	143432	Gray Green	AB	120821			
Light Gray (Coast Guard)	BH	143433	Light Brown	AC	120822			
Light Gray (Navy)	BU	143435	Dark Brown	AD	120823			
Light Gray	BR	143435						
Charcoal Gray	BZ	143436						
Navy Ocean Gray	ED	143437						
Gray Green	BK	143434						

LUBRICANTS							
Grease				Oil			
Part Number	Quantity	Brand Name	Bell System Code	Application	Quantity	Part Number	Bell System Code
88973	1 lb.		KS 7471	General	1 Qt.	88970	KS 7470
97116	4 oz.				1 Gal.	88971	
108805	2 oz.	Lubriplate 105					
143484	1 lb.	Mobil #2					
145867	4 oz.	Mobil #2					
195298	1 lb.	Beacon #325					
301313	1-3/4 oz.	Aero Lubriplate					

ADHESIVE		
Quantity	Application	Part Number
5 Oz.	Felt Pads	143285
1 Pint	Rubber Pads And Insulators	163584
1 Pint	Air Filter	175379

CLEANING CONCENTRATE	
Quantity	Part Number
1 Gal. Can	321052
5 Gal. Can	321078

GASKET MATERIAL	
Description	Part Number
Self-Adhesive Polyurethane 50 Ft. Roll	305713

SHOP TOWELS	
Description	Part Number
Masslinn 12" x 17" Open Size Packed Folded (8-1/2" x 6") in 100 per Cardboard Box Dispenser	310397

### TOOL KITS

113778 Universal Tool Kit contains the following:

Part Number	Description	Page Number	Part Number	Description	Page Number
6617	Wrench, Tommy	3	110443	Scale, 8 oz. Spring	2
72003	Bender, Contact Spring	6	110444	Scale, 32 oz. Spring	2
72574	Tool, Holding	6	113756	Wrench Set	2
72575	Tool, Finger Bending	6	113777	Tool Kit	2
72581	Pin, Gauge	6	116156	Wrench, Spanner	3
73370	Gauge, Locating	7	117781	Gauge Set, Feeler	4
73404	Wrench, Tommy	3	124134	Bender, Contact Spring	6
73408	Magnifier	4	124682	Wrench, Hex Key	3
75503	Hook, Push Spring	4	125752	Wrench, 3/16" Socket	3
75765	Hook, Pull Spring	4	129848	Screwdriver	3
77618	Box, Tool	8	135059	Scale, 15 lb. Spring	2
82711	Scale, 64 oz. Spring	2	142554	Hook, Pull Spring	4
87698	Stone, Carborundum	10	142555	Hook, Push Spring	4
88993	Burnisher, Contact	3	151351	Hook, Pull Spring	4
91117	File, Contact	3	151384	Holder, Screw	3
94644	Screwdriver, 30° Offset	3	151392	Tweezers	4
94645	Screwdriver, 90° Offset	3	151959	Hook, Pull Spring	4
95368	Screwdriver	3	152223	Scale, 70 gram Spring	2
95960	Gauge, Tape	7	321071	Clip, Armature	5
99947	Tool, Punch Block Cleaning	7	159841	Wrench, Hex Key	3
104457	Wrench, Hex Key	3	161686	Tool, Tine	5
110271	Wrench, Hex Key	3	179411	Gauge Set, Feeler	4

TOOL KITS (Continued)

146642 Special Tool Kit (To Supplement The 113778 Tool Kit) contains the following:

Part Number	Description	Page Number	Part Number	Description	Page Number
110445	Bender, Contact Spring	6	145867	Grease, 4 oz. Tube	12
143089	Clip, Armature	7	172060	Bender, Contact Spring	6

151940 Special Tool Kit (Model 28 Page Printer Set) contains the following:

Part Number	Description	Page Number	Part Number	Description	Page Number
73408	Magnifier	4	151392	Tweezers	4
100982	Screwdriver w/Clip	3	151394	Brush, Type Cleaning	4
151351	Hook, Pull Spring	4	151959	Hook, Pull Spring	4
151382	Screwdriver	3	152835	Wrench, 5/16" & 3/8" Cpen End	2
151383	Tool, Keylever Remover	5	152837	Wrench, 3/16" & 1/4" Cpen End	2
151384	Holder, Screw	3	161430	Handwheel	5

159114 Tool Kit (Model 28 Equipment) contains the following:

Part Number	Description	Page Number	Part Number	Description	Page Number
104457	Wrench, Hex Key	3	159841	Wrench, Hex Key	3
129537	Wrench, 9/16" & 3/4" Cpen End	2	159926	Gauge w/Pin, Punch Bail Arm	7
156011	Gauge, Tape	7	160396	Pliers, Retaining Ring	3
156743	Gauge, Tape Lid	6	172060	Bender, Contact Spring	6
159133	Gauge	7			

171312 Tool Kit (High Speed Tape Punch and Tape Reader) contains the following:

Part Number	Description	Page Number	Part Number	Description	Page Number
82711	Scale, 64 oz. Spring	2	110443	Scale, 8 oz. Spring	2
88970	Oil, 1 qt.	12	110444	Scale, 32 oz. Spring	2
88993	Burnisher, Contact	3	110445	Bender, Contact Spring	6
89954	Wrench, 1/4" Socket	3	113756	Wrench Set	2
89955	Wrench, 5/16" Socket	3	117781	Gauge Set, Feeler	4
94644	Screwdriver, 30° Offset	3	129534	Wrench, 3/16" & 1/4" Cpend End	2
94645	Screwdriver, 90° Offset	3	142554	Hook, Pull Spring	4
94646	Stick, Orangewood	7	142555	Hook, Push Spring	4
94647	Screwdriver, 3-1/2" Blade	3	143089	Clip, Armature	7
95960	Gauge, Tape	7	143484	Grease, 1 lb.	12
99947	Tool, Punch Block Cleaning	7	151384	Holder, Screw	3
100704	Screwdriver w/Clip	3	151392	Tweezers	4
103625	Can, Oil	8	152223	Scale, 70 gram Spring	2
104457	Wrench, Hex Key	3	159841	Wrench, Hex Key	3
110442	Screwdriver	3	172060	Bender, Contact Spring	6

185830 Tool Kit (Model 32 and 33 Equipment) contains the following:

Part Number	Description	Page Number	Part Number	Description	Page Number
104457	Wrench, Hex Key	3	180588	Tool, Typewheel Adjusting	9
110445	Bender, Contact Spring	6	180993	Bender, Contact Spring	9
124682	Wrench, Hex Key	3	181465	Adapter, Handwheel	5
125752	Wrench, 3/16" Socket	3	182697	Extractor, Terminal	9
156011	Gauge, Tape	7	183103	Gauge, Tape Reader	4
159841	Wrench, Hex Key	3	184098	Tool, Selector Cam Removal	10
160396	Pliers, Retaining Ring	3	185829	Bender, Contact Spring	10
180587	Tool, Carriage Adjusting	9	199413	Wrench, 3/16" & 1/4" Offset	7

TOOL KITS (Continued)

307523 Tool Kit ( High Speed Send/Receive Set ) contains the following:

Part Number	Description	Page Number	Part Number	Description	Page Number
95960	Gauge, Tape	7	301235	Probe, Nozzle	10
100982	Screwdriver w/Clip	3	301313	Grease, 1-3/4 oz	12
103625	Can, Oil	8	301409	Tool, Magnet Adjusting	5
110443	Scale, 8 oz Spring	2	301486	Pliers, Gripping	3
124682	Wrench, Hex Key	3	301487	Pliers, Gripping	3
129534	Wrench, 3/16" & 1/4" Open End	2	302440	Gauge, Tape Chute	10
129536	Wrench, 7/16" & 1/2" Open End	2	302448	Gauge, Verifier	6
135676	Handle	2	307605	Gauge, (GO) Contact	10
135677	Wrench, 1/4" Socket	2	307606	Gauge, (NO - GO) Contact	10
135678	Wrench, 5/16" Socket	2	307607	Gauge, Contact Alignment	7
142555	Hook, Push Spring	4	310105	Screwdriver, Potentiometer Adjusting	5
145867	Grease, 4 oz. Tube	12	310106	Wrench, 1/8" Hex Key	3
149725	Gauge, Punch Pin Penetration	10	310394	Wiper, Nozzle	8
149836	Cleaner, Punch Block	7	310395	Vise, Pin	8
152835	Wrench, 5/16" & 3/8" Open End	2	310397	Towels, Shop	12
301168	Ink, 12 oz Special	8			

315783 Tool Kit (Self-Contained DRPE Set) contains the following:

Part Number	Description	Page Number	Part Number	Description	Page Number
82711	Scale, 64 oz. Spring	2	110445	Bender, Contact Spring	6
88970	Oil, 1 qt	12	117781	Gauge Set	4
88993	Burnisher, Contact	3	124682	Wrench, Hex Key	3
89954	Wrench, 1/4" Socket	3	129534	Wrench, 3/16" & 1/4" Open End	2
89955	Wrench, 5/16" Socket	3	129536	Wrench, 7/16" & 1/2" Open End	2
94644	Screwdriver, 30° Offset	3	135060	Tool, Roll	2
94645	Screwdriver, 90° Offset	3	142554	Hook, Pull Spring	4
94646	Stick, Orangewood	7	145867	Grease, 4 oz. Tube	12, 13
95960	Gauge, Tape	7	151384	Holder, Screw	3
100982	Screwdriver w/Clip	3	151392	Tweezers	4
103625	Can, Oil	8	152223	Scale, 70 Gram Spring	2
104457	Wrench, Hex Key	3	152835	Wrench, 5/16" & 3/8" Open End	2
108285	Pliers, Long Nose	3	152837	Wrench, 3/16" & 1/4" Open End	2
110442	Screwdriver	3	302448	Gauge, Verifier	6
110443	Scale, 8 oz. Spring	2	308373	Gauge, Punch Pin Penetration	11
110444	Scale, 32 oz. Spring	2			

## NUMERICAL INDEX

Part Number	Description and Page Number	Part Number	Description and Page Number	Part Number	Description and Page Number
6617	Wrench, Tommy 3, 12	96373	Gauge, .010" 4	125752	Wrench, 3/16" Socket 3, 12, 13
7002	Washer, Flat 5	96375	Gauge, .015" 4	125754	Wrench, 1/4" Socket 7
72003	Bender, Contact Spring 6, 12	96377	Gauge, .020" 4	125755	Wrench, 5/16" Socket 7
72574	Tool, Holding 6, 12	96383	Gauge, .035" 4	125756	Wrench, 3/8" Socket 7
72575	Tool, Finger Bending 6, 12	96385	Gauge, .040" 4	125757	Wrench, 7/16" Socket 7
72581	Pin, Gauge 6, 12	96389	Gauge, .045" 4	125758	File, 5-1/4" Contact 3
73370	Gauge, Locating 7, 12	96391	Gauge, .050" 4	125759	Wrench, 1/8" Open End 7
73404	Wrench, Tommy 3, 12	96393	Gauge, .060" 4	125762	Wrench, 5/16" Open End 7
73408	Magnifier 4, 12, 13	96399	Gauge, .065" 4	125765	Wrench, 7/16" & 3/8" Open End 7
73409	Brush, Camel Hair 4	96401	Gauge, .070" 4	125775	Wrench, 3/8" & 7/16" Open End 7
73410	Screwdriver 3	96403	Gauge, .075" 4	125776	Wrench, 5/16" Open End 7
73517	Gauge 7	96405	Gauge, .080" 4	125777	Wrench, 1 4" Open End 7
75503	Hook, Push Spring 4, 12	97116	Grease, 4 Oz 12	125783	Stone, Carborundum 10
75765	Hook, Pull Spring 4, 12	97923	Gauge, .125" 10	126812	Tool, Extracting 10
75766	Tool, Special 10	98055	Bender, Contact Spring 6	129534	Wrench, 3-16" & 1 4" Open End 2, 13, 14
75906	Tool, Local Test 7	98136	Gauge, .037" 4	129535	Wrench, 5 8" & 3 4" Open End 2
77618	Box, Tool 8, 12	98631	Case Assembly 2	129536	Wrench, 7/16" & 1/2" Open End 2, 14
77708	Bender, Contact Spring 10	99391	Gauge 6	129537	Wrench, 9/16" & 3/4" Open End 2, 13
78590	Pliers, Parallel 3	99947	Tool, Punch Block Cleaning 7, 12, 13	129848	Screwdriver 3, 12
82711	Scale, 64 Oz Spring 2, 12, 13, 14	100688	Oiler 8	135059	Scale, 15 Lb Spring 2, 12
84020	Puller, Bearing 8	100704	Screwdriver w/Clip 3, 13	135060	Roll, Tool 2, 14
86965	Handle 8	100982	Screwdriver w/Clip 3, 13, 14	135675	Roll, Tool 2
86966	Shaft, Bearing Puller 8	101082	Wrench, 3/4" Open End 7	135676	Handle 2, 14
86968	Pin, Cotter 8	103534	Tool, Bending 6	135677	Wrench, 1/4" Socket 2, 14
86970	Jaw, Bearing Puller 8	103621	Wrench, Hex Key 3	135678	Wrench, 5/16" Socket 2, 14
87697	Wrench, 1/2" & 3/4" Open End 7	103625	Can, Oil 8, 13, 14	135679	Blade, Adjusting 2
87698	Stone, Carborundum 10, 12	103628	Fork, Tuning 8	135680	Blade, Adjusting 2
88970	Oil, 1 Qt 12, 13, 14	104262	Case, Tuning Fork 8	139676	Drill 7
88971	Oil, 1 Gal 12	104457	Wrench, Hex Key 3, 12, 13, 14	142554	Hook, Pull Spring 4, 12, 13, 14
88973	Grease, 1 Lb 12	104986	Fork, Tuning 8	142555	Hook, Push Spring 4, 12, 13, 14
88975	Gun, Grease 8	107162	Cloth, Twill Jean 9	143089	Clip, Armature 7, 13
88993	Burnisher, Contact 3, 12, 13, 14	108252	Screwdriver 3	143285	Adhesive, 5 Oz Tube 12
89928	Tool, Relay Adjusting 10	108285	Pliers, Long-Nose 3, 14	143431	Paint, 1 Pint 12
89954	Wrench, 1/4" Socket 3, 13, 14	108286	Pliers, Cutting 3	143432	Paint, 1 Pint 12
89955	Wrench, 5/16" Socket 3, 13, 14	108805	Lubriplate, 2 Oz Tube 12	143433	Paint, 1 Pint 12
91117	File, Contact 3, 12	110271	Wrench, Hex Key 3, 12	143434	Paint, 1 Pint 12
91270	Gauge, .060" & .065" 10	110442	Screwdriver 3, 13, 14	143435	Paint, 1 Pint 12
93811	Gauge, .030" 4	110443	Scale, 8 Oz Spring 2, 12, 13, 14	143436	Paint, 1 Pint 12
93814	Holder, Gauge 4	110444	Scale, 32 Oz Spring 2, 12, 13, 14	143437	Paint, 1 Pint 12
93822	Gauge, .004" 4	110445	Bender, Contact Spring 6, 13, 14	143484	Grease, 1 Lb 12, 13
93823	Gauge, .005" 4	113756	Wrench Set 2, 12, 13	145867	Grease, 4 Oz Tube 12, 13, 14
93824	Gauge, .018" 4	113777	Tool Kit 2, 12	146330	Iron, Soldering 5
93825	Gauge, .025" 4	113778	Tool Kit 12	146331	Tip, Soldering Iron 5
93827	Gauge, .055" 4	114199	Bender, Contact Spring 6	146520	Card, EC520 Circuit 9
93828	Gauge, .012" 4	114200	Bender, Contact Spring 6	146521	Card, EC521 Circuit 9
93833	Gauge, .003" 4	114201	Wrench, Closed Offset 7	146538	Case, Circuit Card Carrying 9
94540	Screw, 10-24 Set 5	114202	Bender, Contact Spring 10	146539	Kit, Circuit Card 9
94644	Screwdriver, 30 Deg. Offset 3, 12, 13, 14	114672	Wrench, 3/8" & 7/16" Open End 7	146540	Kit w/Case, Circuit Card 9
94645	Screwdriver, 90 Deg. Offset 3, 12, 13, 14	116156	Wrench, Spanner 3, 12	146605	Tape, 5 Level Test 9
94646	Stick, Orangewood 7, 13, 14	116799	Tool, Bending 6	146606	Tape, 8 Level Test 9
95368	Screwdriver 3, 12	117361	Gauge, Contact Adjusting 10	146642	Tool Kit 13
95960	Gauge, Tape 7, 12, 13, 14	117375	Case, Gauge 4	146861	Tape, 6 Level Test 9
96352	Gauge, .027" 4	117781	Gauge Set, Feeler 4, 12, 13, 14	148101	Tape, 5 Level Test 9
96356	Gauge, .002" 4	118530	Gauge 6	148102	Tape, 8 Level Test 9
96358	Gauge, .002" 4	120820	Paint, 1 Pint 12	148370	Gauge, Punch Pin Penetration 10
96360	Gauge, .006" 4	120821	Paint, 1 Pint 12	148454	Card Assembly, Extension 9
96362	Gauge, .007" 4	120822	Paint, 1 Pint 12	148554	Tape, 8 Level Test 9
96364	Gauge, .010" 4	120823	Paint, 1 Pint 12	149725	Gauge, Punch Pin Penetration 10, 14
96369	Gauge, .006" 4	121038	Wrench, Closed Spanner 3		
96371	Gauge, .008" 4	121550	Bender, Contact Spring 6		
		124134	Bender, Contact Spring 6, 12		
		124479	Gauge, Locating 10		
		124682	Wrench, Hex Key 3, 12, 13, 14		
		124828	Pad 5		

## NUMERICAL INDEX (Continued)

Part Number	Description and Page Number	Part Number	Description and Page Number	Part Number	Description and Page Number
149836	Cleaner, Punch Block 7, 14	172361	Card, EC361 Circuit 9	301235	Probe, Nozzle 10, 14
149902	Gauge, Punch Pin Penetration 11	172363	Card, EC363 Circuit 9	301313	Grease, 1-3/4 Oz 12, 14
150040	Screw, 6-40 x 5/8 Fil 5	172365	Card, EC365 Circuit 9	301409	Tool, Magnet Adjusting 5, 14
151351	Hook, Pull Spring 4, 12, 13	172374	Card, EC374 Circuit 9	301486	Pliers, Gripping 3, 14
151382	Screwdriver 3, 13	172375	Card, EC375 Circuit 9	301487	Pliers, Gripping 3, 14
151383	Tool, Keylever Remover 5, 13	172385	Card, EC385 Circuit 9	302400	Gauge, Tape Chute 10, 14
151384	Holder, Screw 3, 12, 13, 14	172394	Card, EC394 Circuit 9	302448	Gauge, Verifier 6, 14
151392	Tweezers 4, 12, 13, 14	172395	Card, EC395 Circuit 9	304364	Paint, 1 Pint 12 <i>2.75</i>
151394	Brush, Type Cleaning 4, 13	172396	Card, EC396 Circuit 9	304904	Staple, Carrier 10
151627	Rod 5	172401	Card, EC401 Circuit 9	305713	Strip, 50 Ft Roll Foam 12
151940	Tool Set 13	172420	Card, EC420 Circuit 9	305734	Tape, 5 Level Test 9
151959	Hook, Pull Spring 4, 12, 13	172431	Card, EC431 Circuit 9	305735	Tape, 8 Level Test 9
152223	Scale, 70 Gram Spring 2, 12, 13, 14	172450	Card Assembly, Extension 9	305825	Tool, Lamp Extractor 11
152258	Post, 3-3/16" Lg 5	172469	Card, EC469 Circuit 9	307523	Tool Kit 14
152292	Clip, Armature 5	172473	Card, EC473 Circuit 9	307605	Gauge, Go Contact 10, 14
152835	Wrench, 5/16" & 3/8" Open End 2, 13, 14	172475	Card, EC475 Circuit 9	307606	Gauge, No Go Contact 10, 14
152837	Wrench, 3/16" & 1/4" Open End 2, 13, 14	172490	Card, EC490 Circuit 9	307607	Gauge, Contact Alignment 7, 14
153673	Shaft 5	173503	Gauge, Tape Lid 6	307615	Eccentric, Adjusting Tool 10
153797	Depressor, Sprocket Pin 5	175379	Adhesive, 1 Pint 12	308373	Gauge, Punch Pin Penetration 11, 14
153807	Post, 2-33/64" Lg 5	178489	Clip, Armature 5	309356	Gauge, Feedwheel 3
153808	Clamp 5	178833	Connector, Adapter 3 Pt Plug 9	309490	Stud 10
154393	Wrench, 5/32" Open End 2	178902	Gauge, Tape 7	310105	Screwdriver, Potentiometer Adjusting 5, 14
156011	Gauge, Tape 7, 13	179407	Gauge, .090" 4	310106	Wrench, 1/8" Hex Key 3, 14
156170	Bender, Contact Spring 6	179408	Gauge, .100" 4	310394	Wiper, Nozzle 8, 14
156743	Gauge, Tape Lid 6, 13	179409	Gauge, .110" 4	310395	Vise, Pin 8, 14
159114	Tool Kit 13	179410	Gauge, .120" 4	310397	Towels, Shop 12, 14
159133	Gauge 7, 13	179411	Gauge Set, Feeler 4, 12	310413	Gauge, .147" & .153" 4
159841	Wrench, Hex Key 3, 12, 13	179661	Carrier Set 8	310420	Gauge, .130" 4
159926	Gauge w/Pin, Punch Bail Arm 7, 13	180587	Tool, Carriage Adjusting 9, 13	310421	Gauge, .135" 4
160396	Pliers, Retaining Ring 3, 13	180588	Tool, Typewheel Adjusting 9, 13	310422	Gauge, .140" 4
161430	Handwheel 5, 13 <i>1.20</i>	180993	Bender, Contact Spring 9, 13	310423	Gauge, .145" 4
161686	Tool, Tine 5, 12 <i>1.4</i>	181465	Adapter, Handwheel 5, 13	310424	Gauge, .150" 4
163584	Adhesive, 1 Pint 12	182697	Extractor, Terminal 9, 13	310425	Gauge, .280" 4
165800	Gauge, Tape 7	183103	Gauge, Tape Reader 4, 13	310426	Gauge, .320" 4
170283	Gauge, Tape Lid 6	184098	Tool, Selector Cam Removal 10, 13	310430	Gauge Set, Feeler 4
170311	Gauge, Tape Lid 6	185701	Label, Instruction 10	312709	Clip, Armature 5
171312	Tool Kit 13	185702	Label, Instruction 10	315783	Tool Kit 14
172060	Bender, Contact Spring 6, 13	185829	Bender, Contact Spring 10, 13	317212	Splicer w/Roller, Tape 11
172321	Card, EC321 Circuit 9	185830	Tool Kit 13	317325	Patch, Blue Splicing 11
172322	Card, EC322 Circuit 9	185832	Clip, Armature 5	317326	Patch, Red Splicing 11
172323	Card, EC323 Circuit 9	193071	Tool, Terminal Insertion 9	317327	Patch, Lavender Splicing 11
172324	Card, EC324 Circuit 9	194853	Injector, Oil 8	317328	Patch, Green Splicing 11
172325	Card, EC325 Circuit 9	195298	Grease, 1 Lb 12	318603	Tool, Adjusting 5
172326	Card, EC326 Circuit 9	197671	Disk, Indicator 5	318775	Oil, 4 Oz Bottle 10
172333	Card, EC333 Circuit 9	197672	Pointer 5	320279	Tape, 5 Level Test 9
172347	Card, EC347 Circuit 9	197673	Modification Kit 5	321052	Concentrate, 1 Gal Cleaning 12
172351	Card, EC351 Circuit 9	199367	Post, 1-51/64" Lg 5	321071	Clip, Armature 5, 12
172352	Card, EC352 Circuit 9	199382	Maintenance Kit 5	321078	Concentrate, 5 Gal Cleaning 12
172355	Card, EC355 Circuit 9	199383	Post, 3-7/32" Lg 5	321942	Chart, Code 11
172359	Card, EC359 Circuit 9	199384	Post, 3-1/2" Lg 5		
		199413	Wrench, 3/16" & 1/4" Offset Open End 7, 13		
		301168	Ink, 12 Oz Special 8, 14		