

Restricted

INSTRUCTIONS FOR INSTALLATION
AND OPERATION OF MODEL
**FSC FREQUENCY
SHIFT CONVERTER**

NAVSHIPS 900,078

PREPARED BY CHIEF OF NAVAL OPERATIONS AND
RADIO LABORATORY, NAVY YARD, WASHINGTON, D. C.

AWAMM-42

Antique Wireless Museum, Bloomfield, NY

PUBLISHED BY ELECTRONICS DIVISION
BUREAU OF SHIPS • NAVY DEPARTMENT

Bureau of Ships,
Navy Department,
Washington 25, D.C.

February 1, 1945

1. INSTRUCTIONS FOR INSTALLATION AND OPERATION OF MODEL FSC FREQUENCY SHIFT CONVERTER (Navships 900,078) is a RESTRICTED Publication.
2. This publication is intended for the use of Naval personnel (officer, enlisted and civilian) who are engaged in the installation, maintenance and operation of this equipment.
3. Additional copies of this publication may be obtained from the Bureau of Ships, Navy Department, Washington 25, D.C.

J. B. Dow
Captain, USN

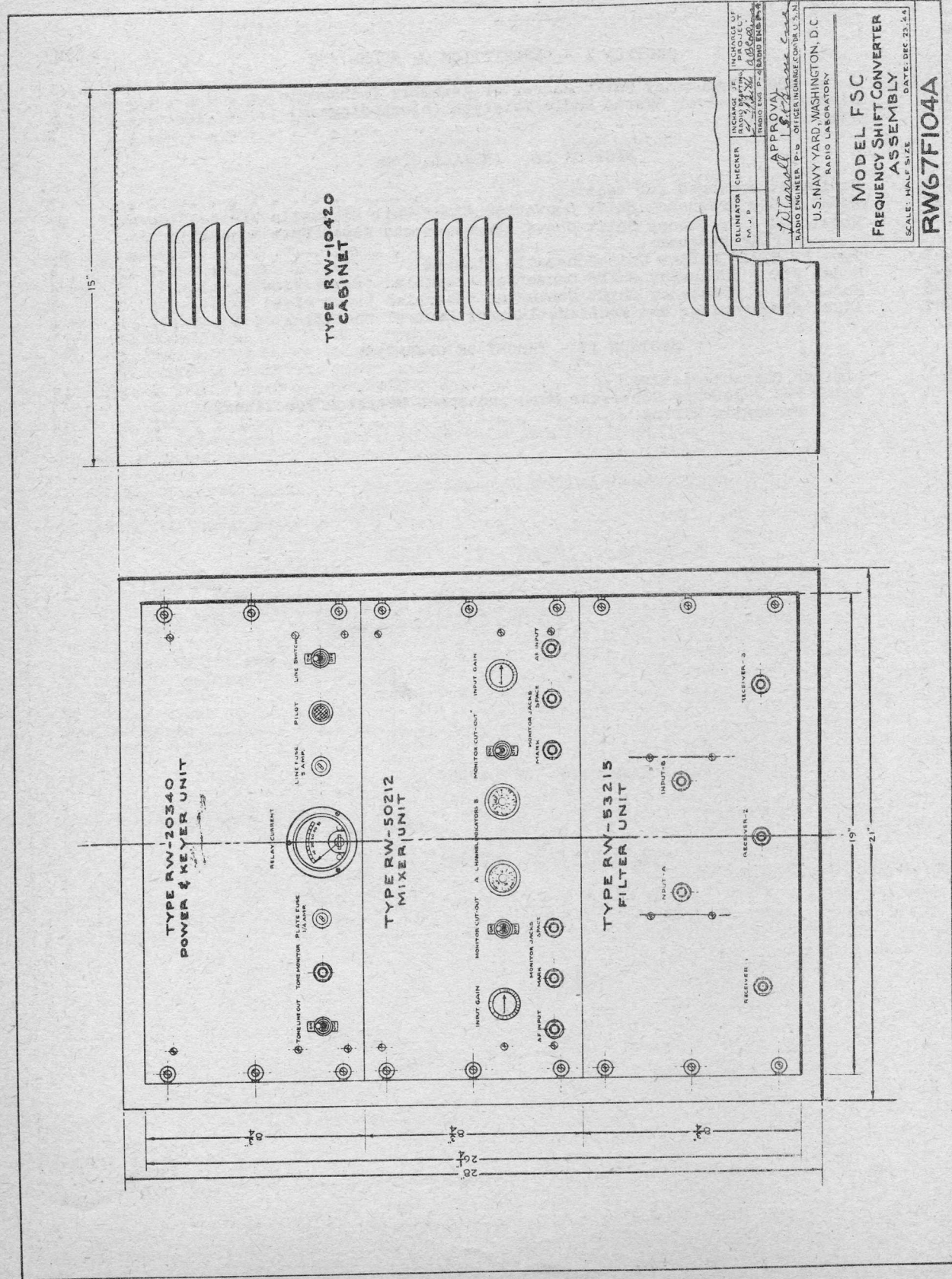

Model FSC - Frequency Shift Converter Assembly (schematic)

Restricted

