

28 TRANSMITTER AND TRANSMITTER - DISTRIBUTOR COVER (LXDC)
AND
28 TABLE (LT)
PARTS

FIGURE	CONTENTS	PAGE
1	Covers	2
2	173375** Cover Assembly	3
3	Cover for Multiple Mounted Units	4
4	Table (w/Half Door)	5
5	Table (w/Full Door)	6
6	Table (w/Full Door-Continued)	7
	Numerical Index	8

PAINT FINISH COLOR CODE CHART				
COLOR	Finish Suffixes			
	Wrinkle Finish	Smooth Finish	Textured Vinyl	Smooth Vinyl
Black	AA(37)	BA(34)		
Black, High Gloss				
Brown, Dark	AD(38)			
Brown, Light	AC(39)			
Gray, Green	AB(40)		GA(45)	
Gray, Light				HB(68)
Gray, Olive				HF(46)
Green, Gray	AB(40)		GA(45)	

The double asterisk (**) denotes a painted part.
Suffix to be applied following the part number.
Number in parentheses indicates Bell System Code.

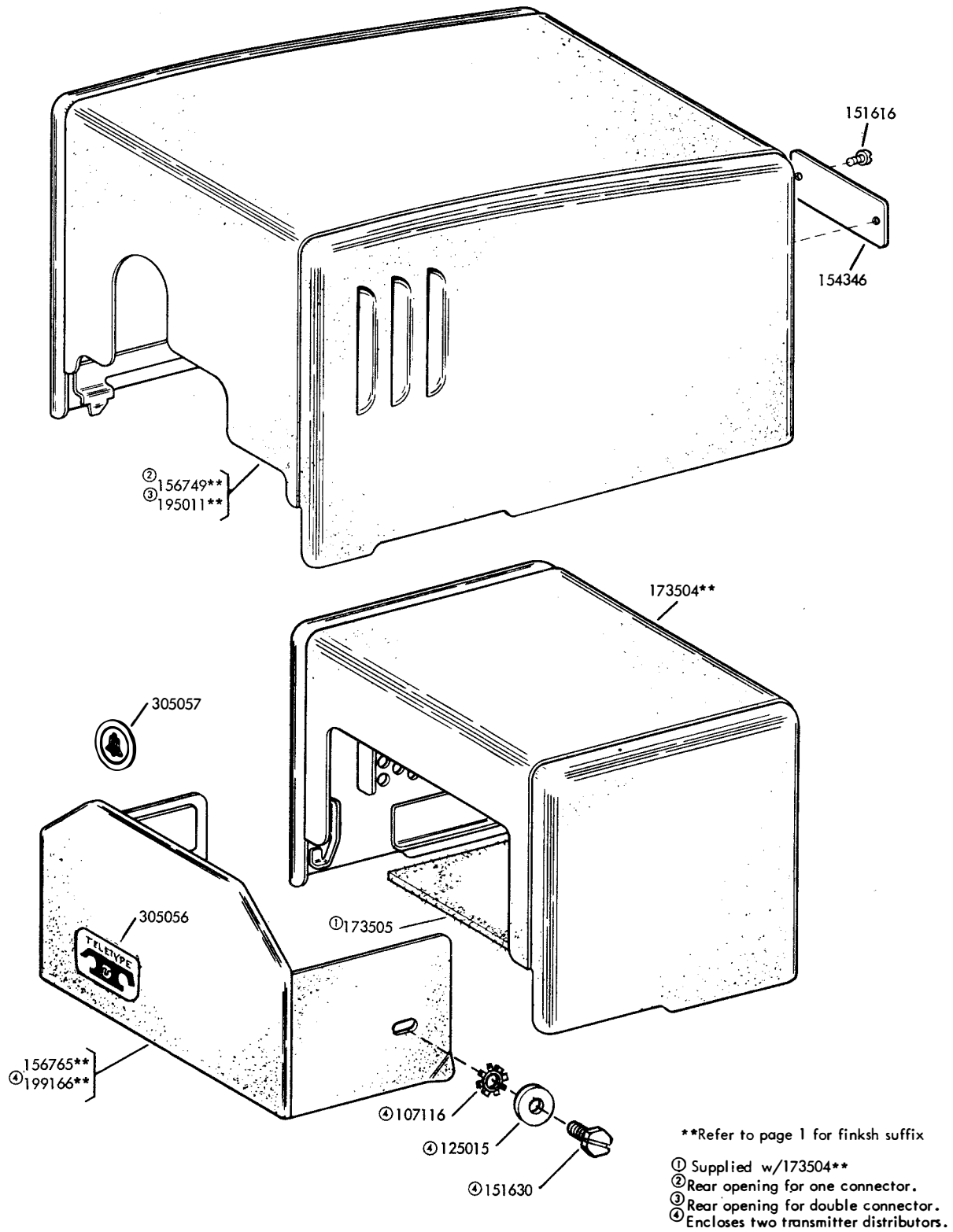
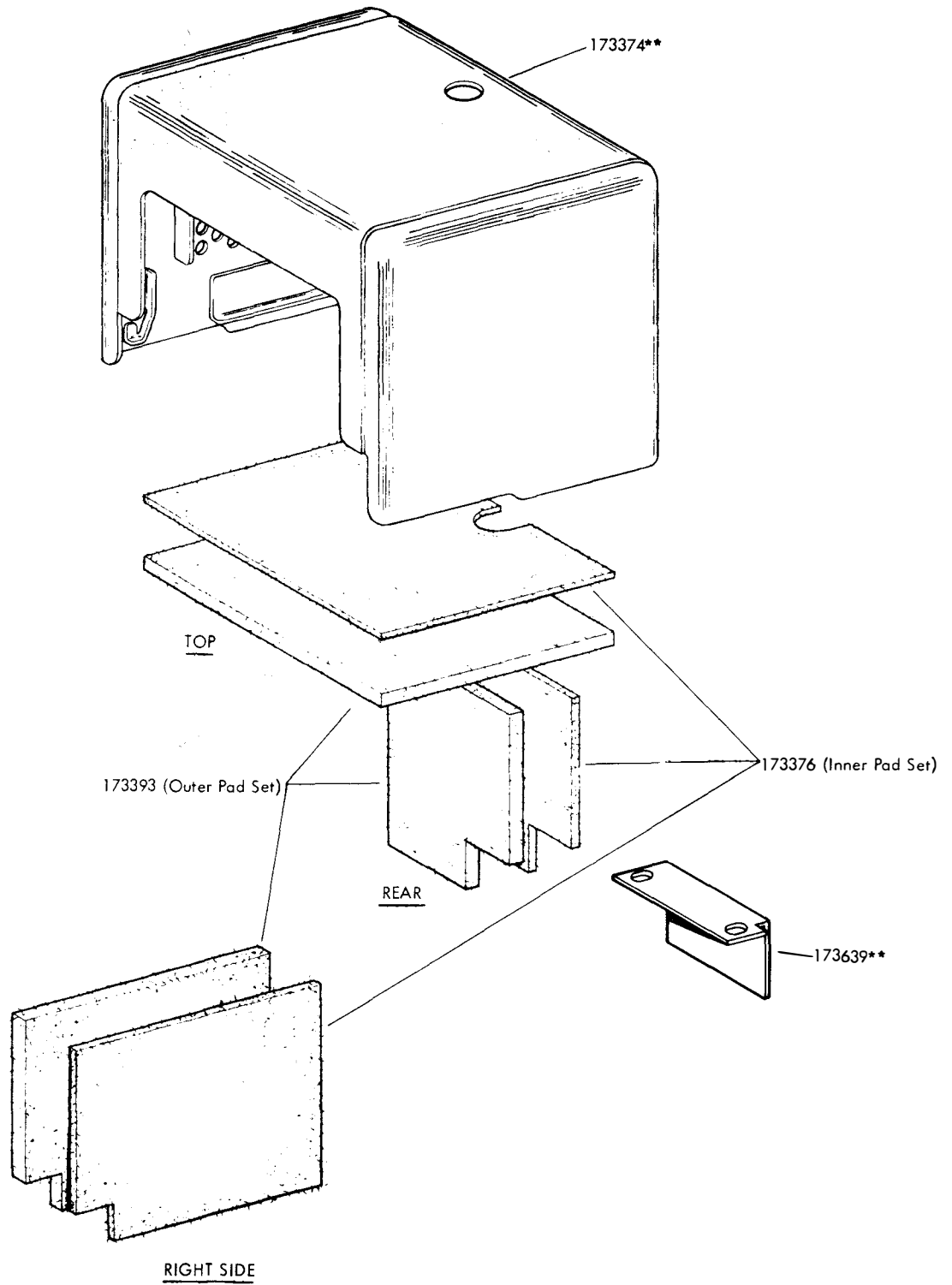
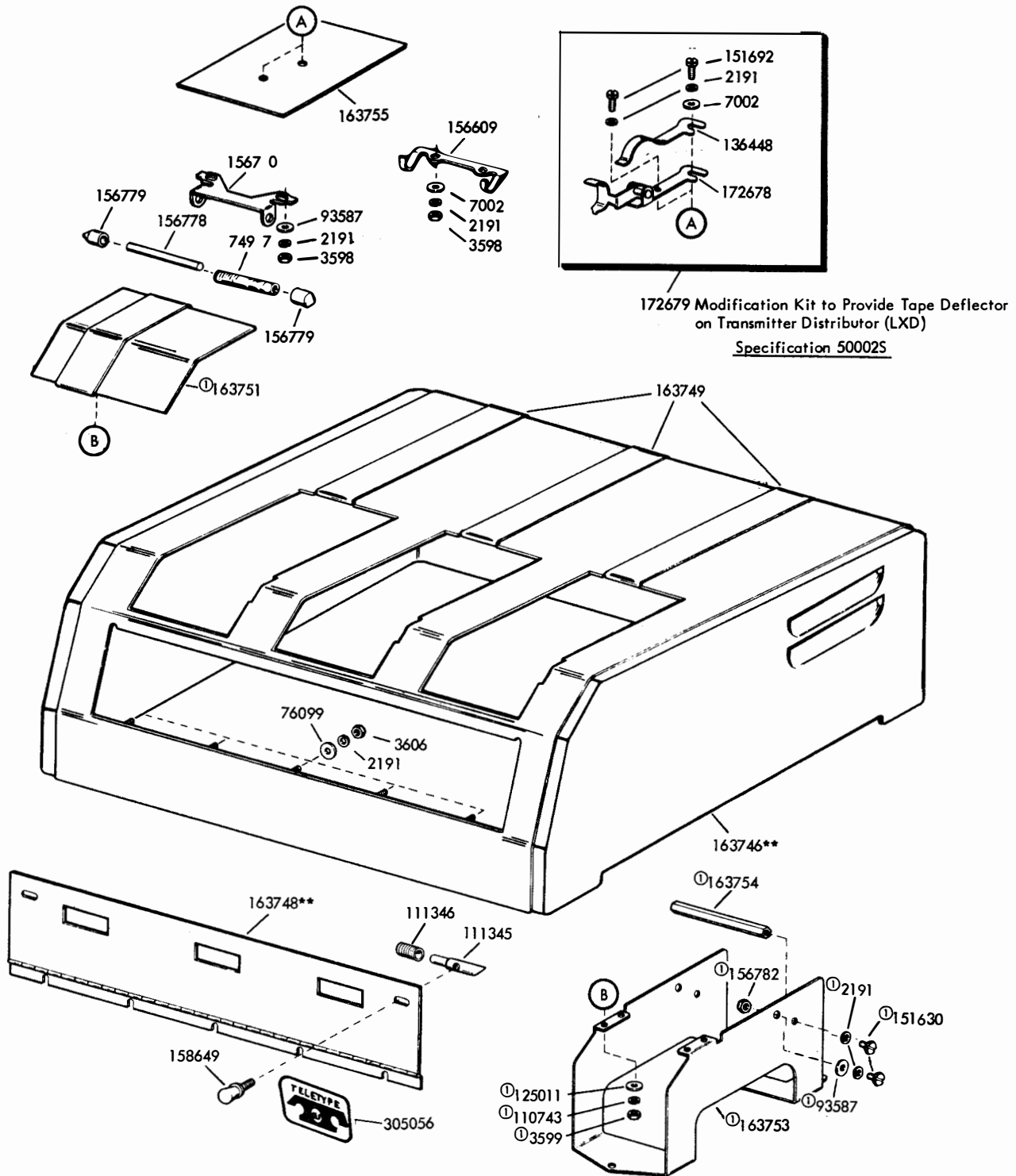

FIGURE 1. COVERS



**Refer to page 1 for finish suffix

FIGURE 2. 173375** COVER ASSEMBLY



172679 Modification Kit to Provide Tape Deflector on Transmitter Distributor (LXD)

Specification 500025

**Refer to page 1 for finish suffix

①163752 Modification Kit to Provide a Dummy Unit for the Multiple Transmitter Distributor Base.
Specification 59815

FIGURE 3. COVER FOR MULTIPLE MOUNTED UNITS

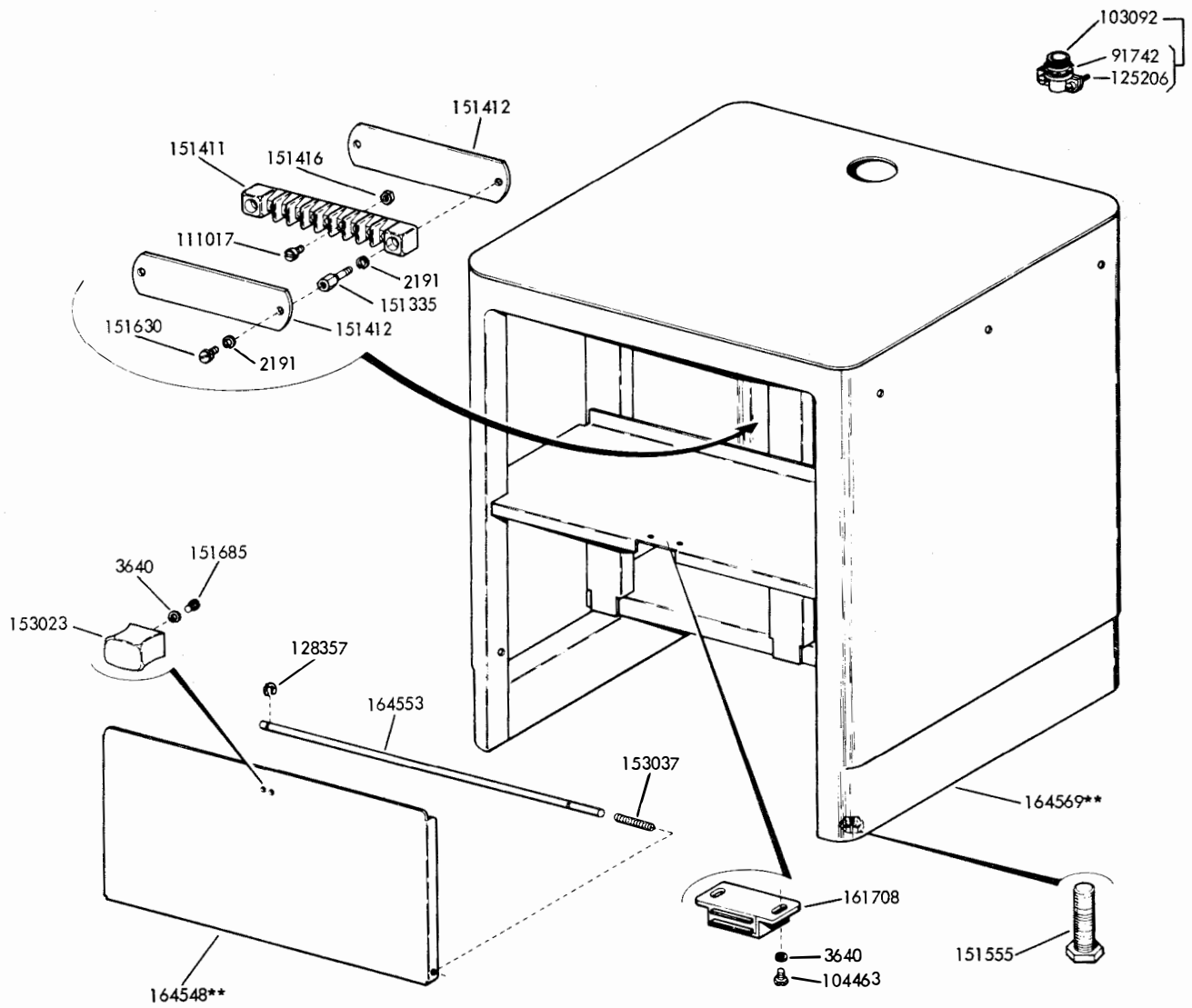

**Refer to page 1 for finish suffix

FIGURE 4. TABLE (w/Half Door)

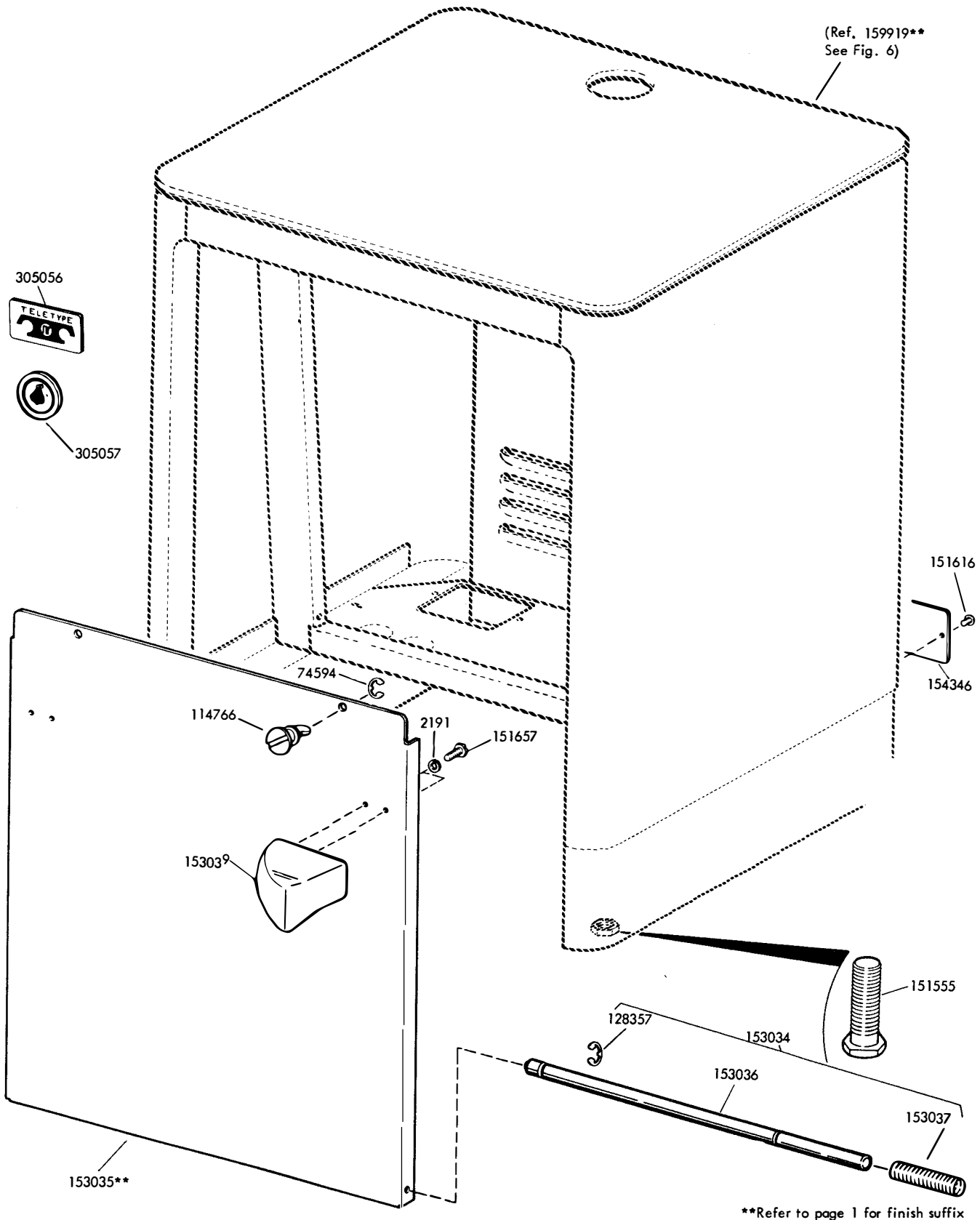

FIGURE 5. TABLE (w/Full Door)

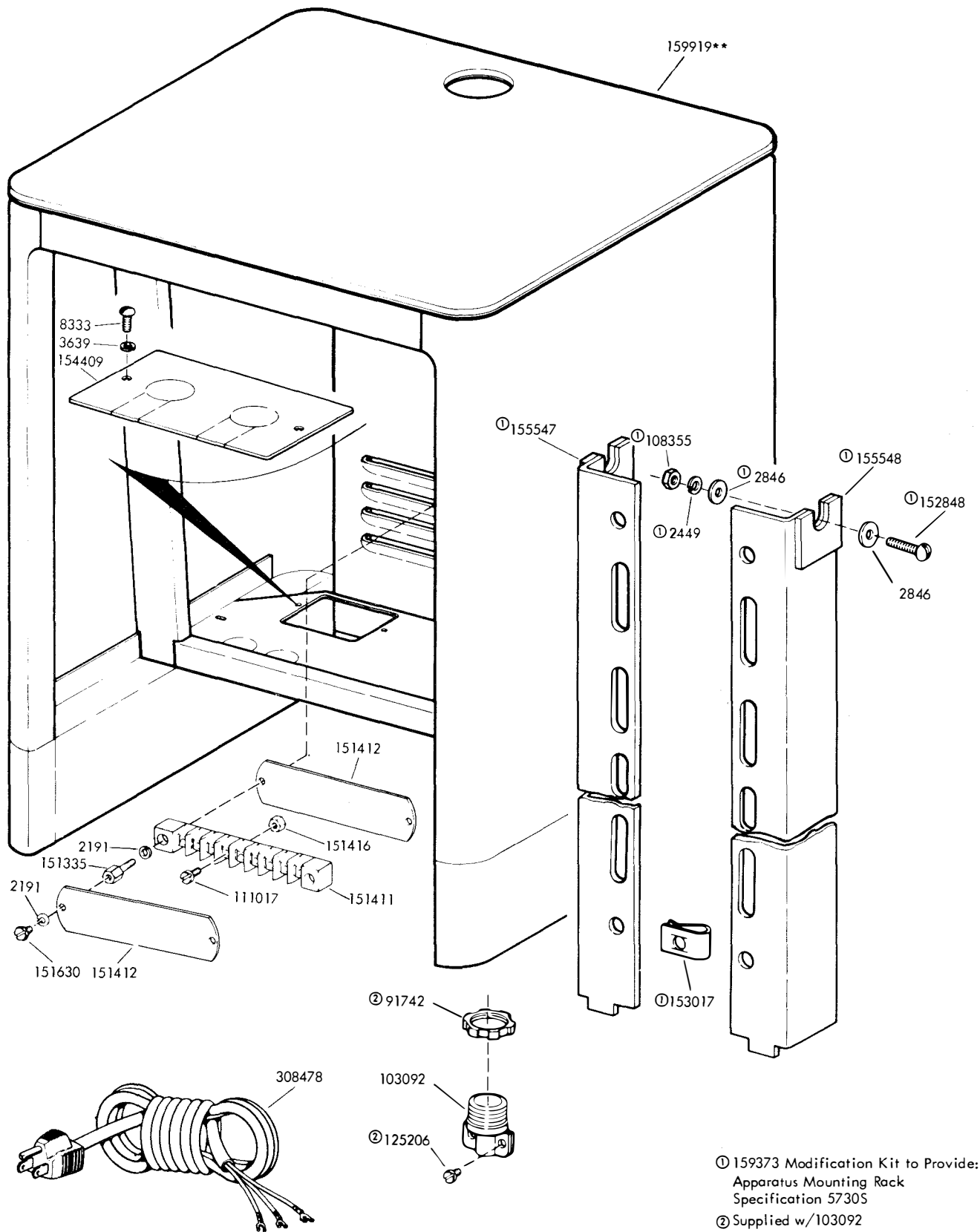

FIGURE 6. TABLE (w/Full Door - Continued)

NUMERICAL INDEX

Part Number	Description and Page Number	Part Number	Description and Page Number	Part Number	Description and Page Number
2191	Washer, Lock 4,5,6,7	151335	Stud 5,7	158649	Screw, 4-40 Thumb 4
2449	Washer, Lock 7	151411	Block, Terminal 5,7	159373	Modification Kit 7
2846	Washer, Flat 7	151412	Insulator, Terminal Block 5,7	159919**	Table, Assembly 6,7
3598	Nut, 6-40 Hex 4	151416	Nut, 6-40 Hex 5,7	161708	Latch, Magnetic 5
3599	Nut, 4-40 Hex 4	151555	Foot, Mounting 5,6	163746**	Cover w/Studs 4
3606	Nut, 6-40 Hex 4	151616	Screw, #2 Self-Tapping 2,6	163748**	Panel w/Bracket 4
3639	Washer, Lock 7	151630	Screw, 6-40 x 1/4 Hex 2,4,5,7	163749	Strip, Cover 4
3640	Washer, Lock 5	151657	Screw, 6-40 x 1/4 Fil 6	163751	Plate, Dummy 4
7002	Washer, Flat 4	151685	Screw, 4-40 x 5/16 Fil 5	163752	Modification Kit 4
8333	Screw, 10-32 x 3/8 Rd 7	151692	Screw, 6-40 x 3/16 Fil 4	163753	Bracket, Dummy 4
74594	Ring, Retaining 6	152848	Screw, 1/4-20 x 3/4 Rd 7	163754	Post 4
74987	Spring, Compression 4	153017	Handle 5	163755	Plate w/Studs 4
76099	Washer, Flat 4	153023	Handle 5	164548**	Panel 5
91742	Nut, Lock 5,7	153034	Shaft, Assembly 6	164553	Shaft 5
93587	Washer, Flat 4	153035**	Panel 6	164569**	Table 5
103092	Connector, Cord 5,7	153036	Shaft 6	172678	Deflector, Tape 4
104463	Screw, 4-40 x 1/4 Hex 5	153037	Spring 5,6	172679	Modification Kit 4
107116	Washer, Lock 2	153039	Handle 6	173374**	Cover 3
108355	Nut, 1/4-20 Hex 7	154346	Plate, Insulation 2,6	173375**	Cover Assembly 1,3
110743	Washer, Lock 4	154409	Plate 7	173376	Pad Set 3
111017	Screw, 6-40 x 5/16 Fil 5,7	155547	Bracket, Left 7	173393	Pad Set 3
111345	Bolt 4	155548	Bracket, Right 7	173504**	Cover w/Pad 2
111346	Spring, Compression 4	156609	Plate, Spring 4	173505	Pad Cover 2
114766	Stud 6	156749**	Cover w/Brackets 2	173639**	Plate, Cover 3
125011	Washer, Flat 4	156765**	Panel, Snap 2	195011**	Cover w/Bracket 2
125015	Washer, Flat 2	156778	Rod 4	199166**	Panel 2
125206	Screw, 6-32 x 5/8 Fil 5,7	156779	Plunger 4	305056	Plate, Identification 2,4,6
128357	Ring, Retaining 5,6	156780	Bracket, Detent 4	305057	Plate, Identification 2,6
136448	Spring, Flat 4	156782	Nut, 6-40 Spl 4	308478	Cord, Power 7

**Refer to page 1 for finish suffix